

FLOOR STANDING DRINKING FOUNTAIN

PRODUCT CODE
CWS
FSDFA 471
MAY 2010

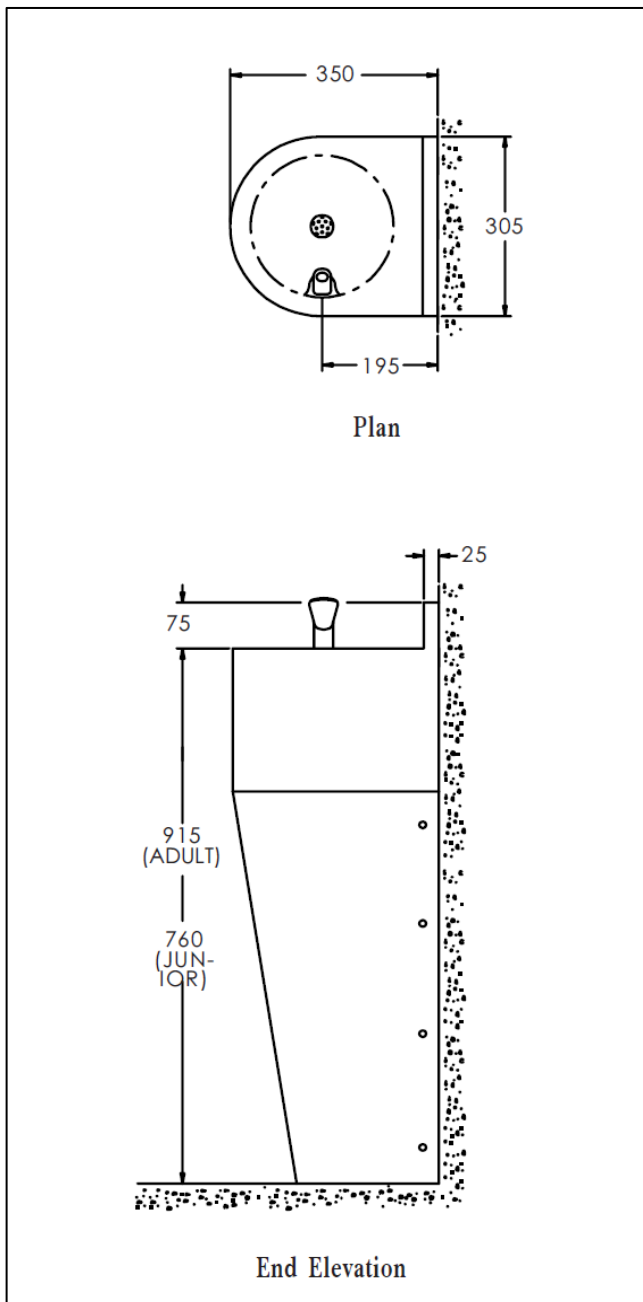

Installation

The Drinking fountain should be installed with the top edge horizontal and the edges sealed against the wall with a permanent impermeable joint.

The drinking fountain should be fitted to the wall at a height generally in accordance with the product data sheet. The lower section should be removed from the mounting frame and the frame should be secured to the wall and floor. The base plate should be removed from the upper section and the plate discarded. The wall-mounting bracket should be screwed to the wall at the appropriate height so that the frame can be screwed up into the captive nuts when the upper section is hung from the bracket. The upper section should then be fixed to the wall through the two holes at the rear of the casing.

The flush grated waste fitting and the bubbler valve should be fitted to the appropriate holes in the casing. Ensure that the pin in the bubbler valve is located in the hole in the casing to stop the bubbler valve rotating. PTFE sealing tape should be applied to the male thread of the brass fitting to ensure a seal with the bubbler valve.

The waste and the bubbler valve should be connected to the drainpipe and the water supply.

Removing the chrome-plated nut around the push button and adjusting the screwdriver slot underneath can alter the height of the water jet. This can be completed with the water connected.

The lower cover can now be fitted to the mounting frame using the security screws provided.

Earthing Continuity

All drinking fountains are provided with a number of fixing points on to which an earthing continuity wire with an end terminal can be secured.

Maintenance

Routine cleaning is necessary to maintain the appearance of stainless steel. Washing with soap or a mild detergent and warm water, applied with a sponge or bristle brush, followed by a clear water rinse is all that is required.

For further information please see our 'Care and Maintenance of Stainless Steel' leaflet.

Warning

If the drinking fountain is to be mounted outside, in accordance with good plumbing practice the supply and valve should be isolated and drained down during winter months to prevent freezing.

Unit 1, Elphicks Farm, Spelmonden Road, Horsmonden, Tonbridge. Kent TN12 8EL
Phone: 01580 211648 E-mail: info@cactuswatersystems.co.uk